

TYPICAL DRAWING MASJID AREA 30'-0"X18'-0" WITH STAIR

SCHEDULE OF DOOR, WINDOWS	
D	8'-0"X10'-6"
D1	2'-6"X7'-0"
W	6'-0"X8'-0"
W1	4'-0"X8'-0"

SCHEDULE OF HEIGHT	
G.F.MASJID	14'-0"

SCHEDULE OF AREA	
TOTAL AREA 18'-0"X30'-0"	= 540.00 SQ.FT
OR	= 60.00SQ.YD

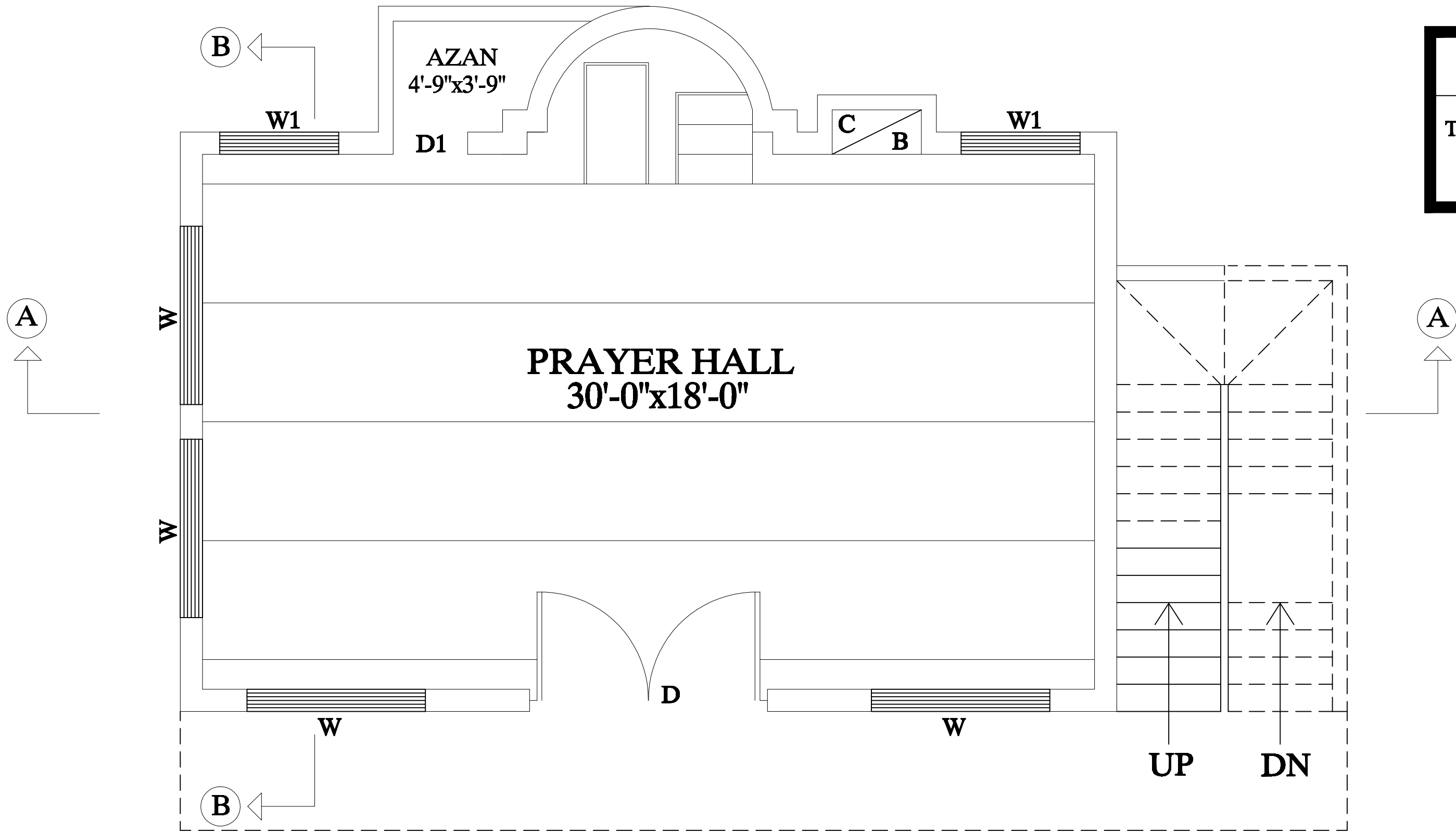

GROUND FLOOR PLAN

01	04-08-2018	
MARK	DATE	ISSUED FOR
		MAJLIS-E-TAMIRAT DAWAT-E-ISLAMI FAIZAN-E-MADINA (OLD SUBZI MANDI) BABUL MADINA (KARACHI) Email. <i>tamirat.babulmadina@dawateislami.net</i>
CLIENT : DAWAT-E-ISLAMI, ATTARI KABINAT KARACHI.		
PROJECT : TYPICAL DRAWING MASJID AREA 30'-0"X18'-0" WITH STAIR		
TITLE: GROUND FLOOR PLAN		
CHECKED BY: SALEEM ATTARI		DRAWN BY: SHABBIR FAROOQUI
DATE:	04-08-2018	Drawing NO: A-01
SCALE:	NTS	JOB. NO: 00